

Joseph Stackhouse & Jns H. Solt
in Right of Nathan Beach

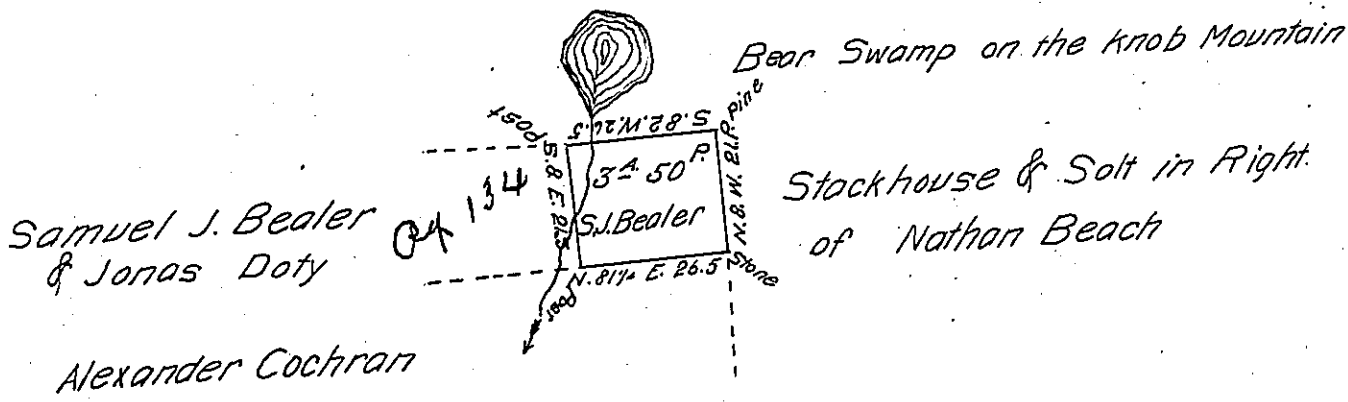

Excess 8 cts

Situate in Briar Creek Township Columbia County Containing Three
Acres and fifty perches and Allowance &c, Surveyed the 25th day of
January A.D. 1862 unto Samuel J. Bealer, By Virtue of his Warrant
dated August 21st 1861 By

Solomon Neyhard C.S. of Columbia Co.

To Henry Southers Esq^r
Surveyor General of Penn^a }

IN TESTIMONY that the above is a copy of the original remaining on file in
the Department of Internal Affairs of Pennsylvania, made
conformably to an Act of Assembly approved the 16th day of
February, 1833, I have hereunto set my Hand and caused
the Seal of said Department to be affixed at Harrisburg,
this fourteenth day of March 1904

June D. Brown
Secretary of Internal Affairs.